

## Circular hand saw - F 012 67M 800 - SPT67M8

Item	Part Number	Description	Illustration	Price	Quantity	Price Group
2	1 619 X08 831	Field 120V	1	\$ 22.00	1	32
3	1 619 X09 733	Armature	1	\$ 19.50	1	31
4	1 619 X08 948	Switch	1	\$ 7.57	1	22
5	1 619 X09 037	Power supply cord	1	\$ 13.70	1	27
13	1 619 P01 511	Ball Bearing	1	\$ 2.94	1	16
14	1 619 X01 015	Ball Bearing	1	\$ 2.58	1	15
19	1 619 X09 511	Screw	1	\$ 0.68	2	10
20	1 619 X09 161	Warning Label	1	\$ 0.68	1	10
21	1 619 X00 938	Screw	1	\$ 0.68	1	10
23	1 619 X01 011	Screw	1	\$ 0.68	4	10
24	1 619 X09 741	Upper guard	1	\$ 24.00	1	33
25	1 619 X09 746	Gear Shaft	1	\$ 13.70	1	27
27	1 619 X06 242	Bushing	1	\$ 0.68	1	10
28	1 619 X00 659	Washer	1	\$ 1.36	1	12
29	1 619 X00 660	Washer	1	\$ 1.12	1	11
30	1 619 X08 860	Cable	1	\$ 1.12	2	11
31	1 619 X08 840	Cable	1	\$ 1.12	1	11
32	1 619 X09 924	Cable	1	\$ 1.36	1	12
33	1 619 X04 693	Lower guard	1	\$ 11.12	1	25
34	1 619 X04 765	Extension Spring	1	\$ 1.12	1	11
35	1 619 X07 688	Lever	1	\$ 0.68	1	10
36	2 610 341 359	Spring retaining ring	1	\$ 1.12	1	11
37	1 619 X09 737	Set Of Handles	1	\$ 6.57	1	21
38	1 619 X04 754	Screw	1	\$ 0.68	2	10
39	1 619 X01 439	Screw	1	\$ 0.68	1	10
41	1 619 X06 749	Screw	1	\$ 0.68	4	10
42	1 619 X09 812	Bolt	1	\$ 0.68	1	10
43	1 619 X00 676	Roller Pin	1	\$ 1.12	1	11
44	1 619 X09 814	Nut	1	\$ 0.68	2	10
45	1 619 X09 751	Locking Lever	1	\$ 1.70	1	13
46	1 619 X09 150	Clip	1	\$ 0.68	2	10
48	1 619 X09 064	Stopper	1	\$ 0.68	1	10

Item	Part Number	Description	Illustration	Price	Quantity	Price Group
49	1 619 X09 743	Locking Lever	1	\$ 1.70	1	13
50	2 610 932 332	Screw	1	\$ 0.68	1	10
51	1 619 P02 503	Hexagon Bolt	1	\$ 0.68	1	10
52	1 619 P01 127	Rubber Ring	1	\$ 1.36	1	12
53	1 619 X08 308	Grommet	1	\$ 2.94	1	16
55	1 619 X01 017	O-Ring	1	\$ 0.68	1	10
69	2 610 025 684	Retaining ring	1	\$ 1.12	1	11
81	1 619 X06 254	Washer	1	\$ 0.68	1	10
83	1 619 X09 747	Locking Bolt	1	\$ 1.12	1	11
84	2 604 610 096	Compression Spring	1	\$ 1.12	1	11
86	1 619 X00 942	Washer	1	\$ 1.12	1	11
88	2 610 993 191	Cable Clip	1	\$ 0.68	1	10
89	1 619 X00 504	Screw	1	\$ 0.68	2	10
92	1 619 X09 735	Baffle	1	\$ 1.12	1	11
99	1 619 X01 268	Device cap	1	\$ 1.12	2	11
100	1 619 X09 684	Screw	1	\$ 0.68	1	10
107	2 610 911 889	Set screw	1	\$ 1.12	1	11
110	1 619 P01 535	Washer	1	\$ 1.36	2	12
111	2 610 912 616	Washer	1	\$ 0.68	1	10
320	1 619 X04 669	Spring	1	\$ 0.68	1	10
651	1 619 X09 459	Wrench Socket	1	\$ 2.58	1	15
801	1 619 X09 860	Motor Housing	1	\$ 30.50	1	35
808	1 619 X09 835	Nameplate	1	\$ 0.68	1	10
810	1 619 X09 861	Brush-Spring Set	1	\$ 4.94	1	19
890	1 619 X09 862	Base Plate	1	\$ 30.50	1	35

Illustration - Type E

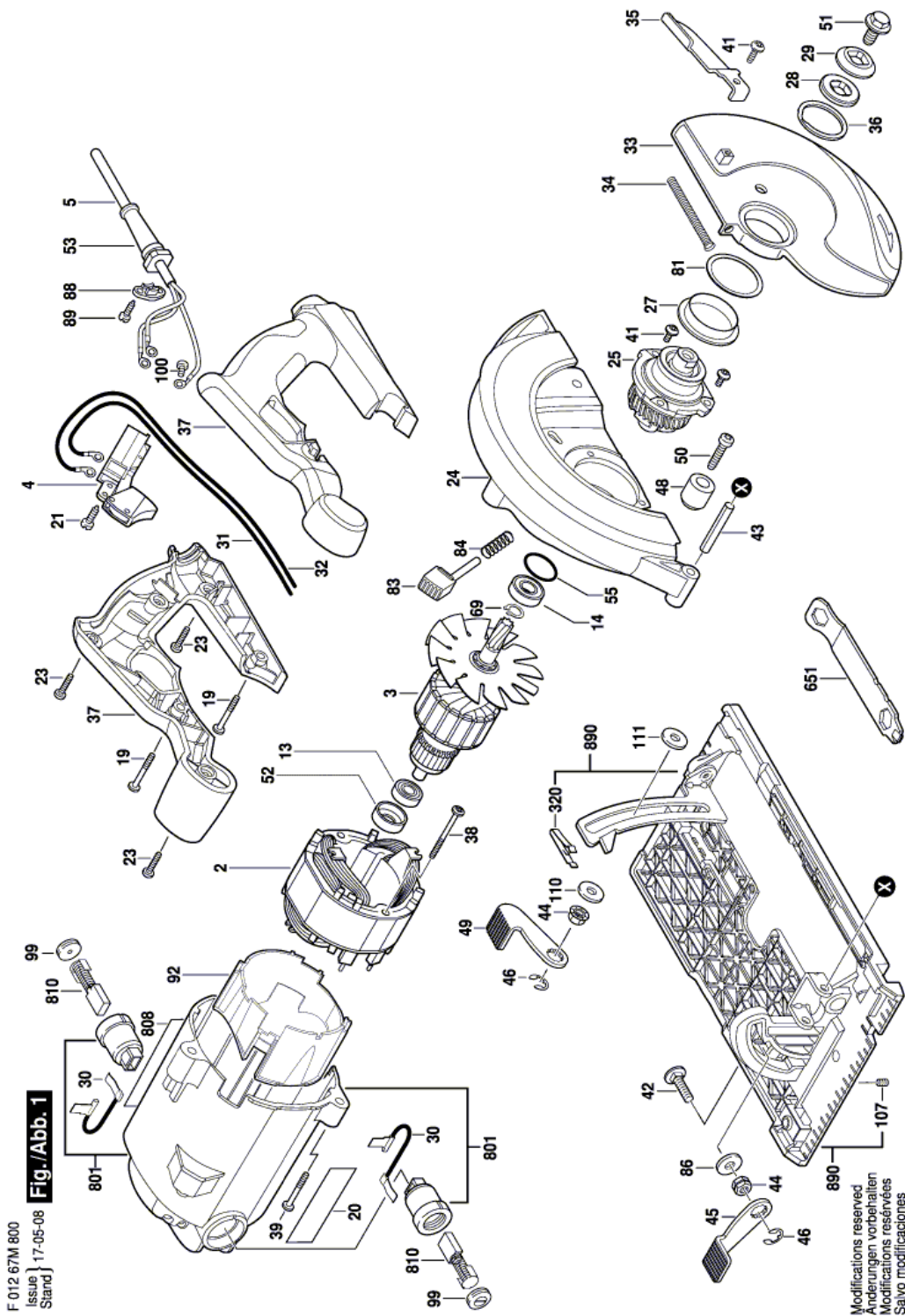

Information subject to change without further notice.